

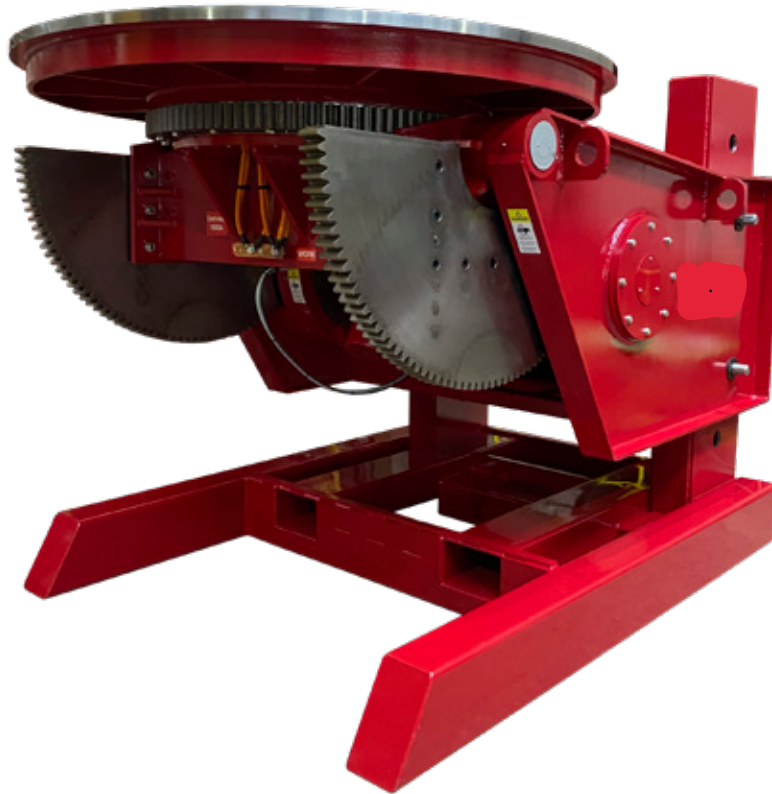

AHVP10

Adjustable Height Welding Positioner



Specification

Model	AHVP 10
Capacity	10 Tonne (22,050lb)
C. O. G. / Eccentricity	500mm (19.7in) / 300mm (11.8in)
Table Diameter	1830mm (72in) with 6 x 42mm (1.6in) slots
Table Height (Horizontal)	1550mm (61in) 1900mm (74.8in) 2250mm (88.5in)
Table Height Centre Line (Vertical)	1295mm (50.9in) 1645mm (64.7in) 1995mm (78.5in)
Degree of Tilting	135°
Table Rotation Speed	0.033 - 0.66rpm
Tilt Speed	150 seconds for 135°
Control/Pendant	Tilt-Up/Tilt-Down/Forward/Stop/Reverse/Speed Control/Emergency Stop - 15m cable
Power Supply	380-480V, 3 Phase, 50/60Hz
Control Panel	AC Control 16Amp
Earthing	600Amp
Weight	7500Kg (16,535lb)
Dimensions LxWxH (Table at lowest point)	L2990mm x W2250mm x H1965mm (L117.7in x W88.5in x H77.4in)

Westermans International Ltd
Unit 4 Midland Distribution Centre,
Markfield Road, Groby
Leicestershire, LE6 0FS

www.westermans.com welding@westermans.com Tel:+44(0) 116 2696941



AHVP10

Adjustable Height Welding Positioner

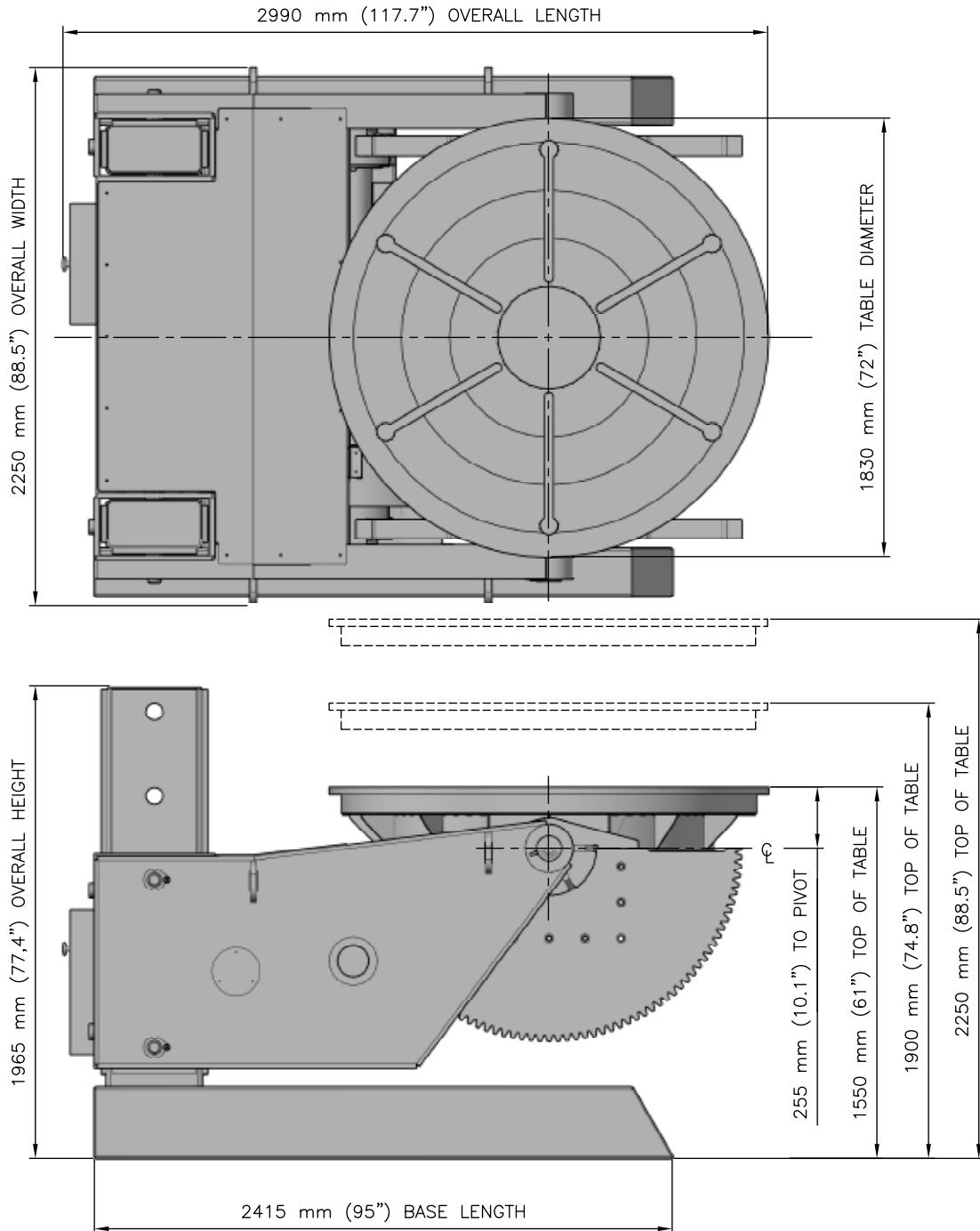

Westermans International Ltd
Unit 4 Midland Distribution Centre,
Markfield Road, Groby
Leicestershire, LE6 0FS

www.westermans.com welding@westermans.com Tel:+44(0) 116 2696941